



BNC (F)
4240-125



LT (M)
4240-012



TNC (F)
4240-156



BNC (M)
4240-132

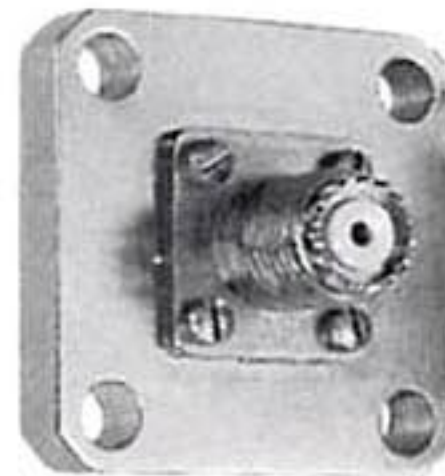

Mini-UHF (F)
4240-346



TNC (M)
4240-160



C (F)
4240-100



N (F)
4240-062

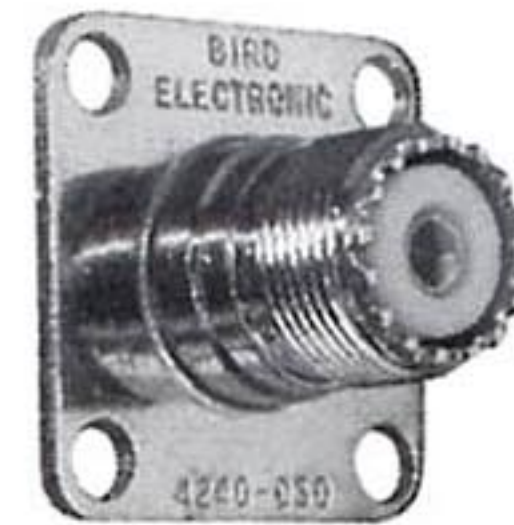

UHF (F)
4240-050



HN (F)
4240-268



N (M)
4240-063

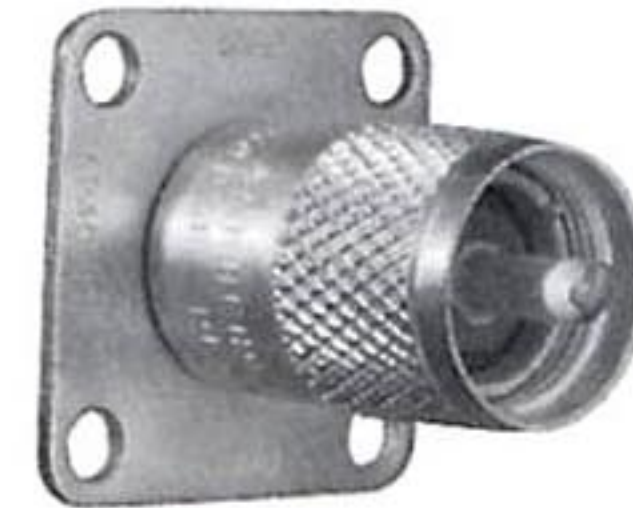

UHF (M)
4240-179

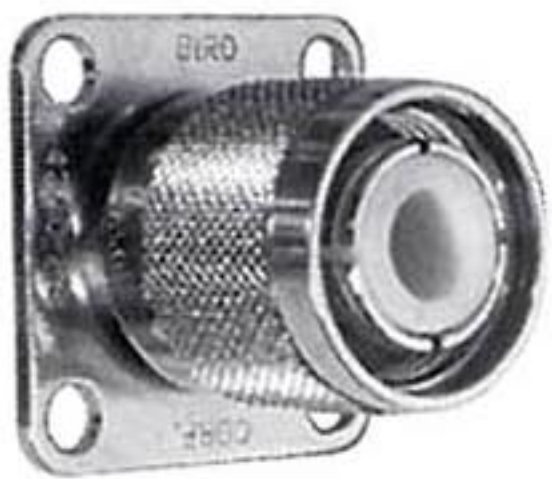

HN (M)
4240-278

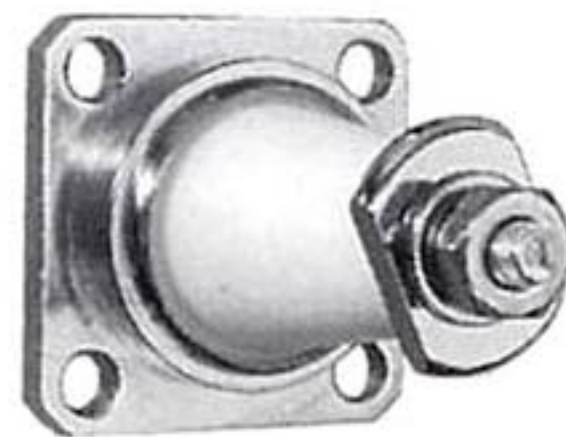

**Open Term.
#10-32 Nut**
4240-080



7/8" EIA
4240-002



LC (F)
4240-031



SC (F)
4240-090

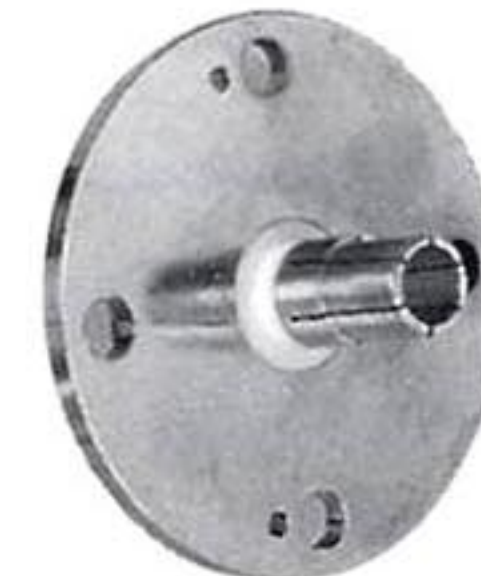

**1 5/8" EIA
Fixed**
4240-096



LC (M)
4240-025

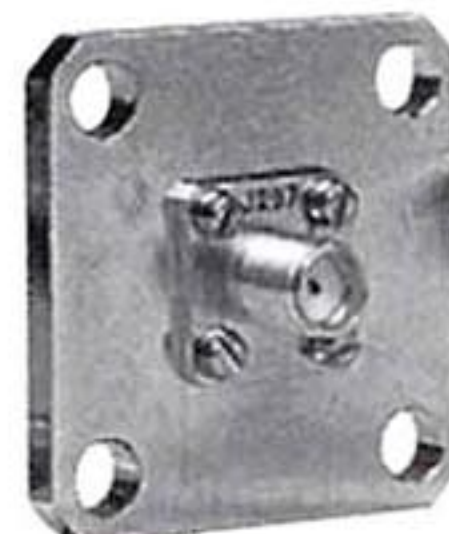

SMA (F)
4240-336

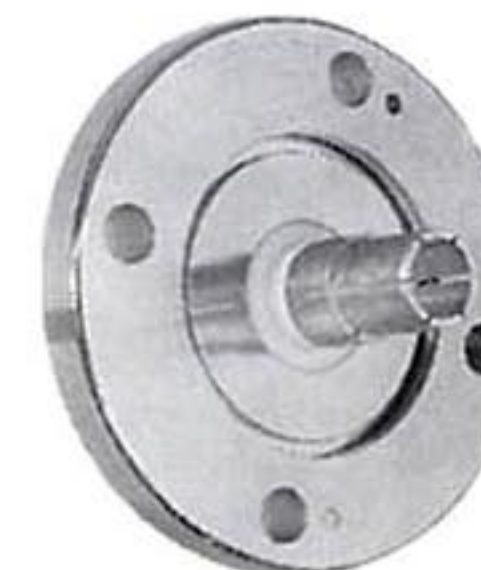

**1 5/8" EIA
Swivel**
4240-208

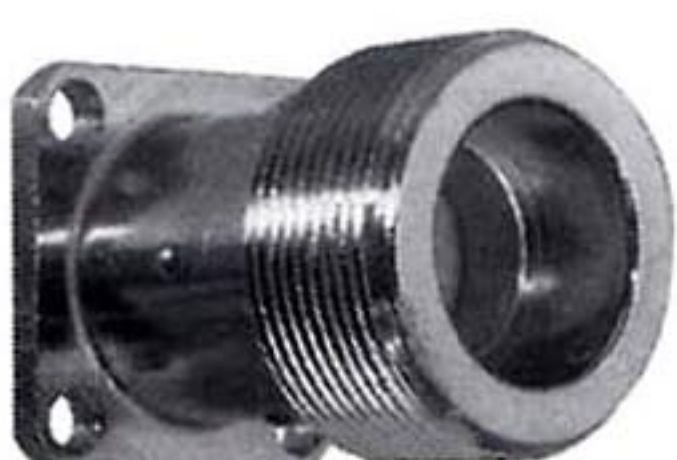

LT (F)
4240-018



SMA (M)
4240-334



**DIN (M)
IEC 7/16 (M)
Type 169-4**
4240-363